

Couplings

Double Loop

Couplings Double Loop



Materials & Finishes

- Hubs:** *Steel 230M07 pb Zn plated + clear passivate
OR
Stainless Steel 303 S31 natural finish*
- Flexing Element:** *Hytrel*
- Fastener:** *Steel Hub: Alloy steel, black oiled
Stainless Steel Hub: stainless steel*

General description

Exceptional flexibility in all three directions, radial, angular and axial.

Where to use

Light power drives, pumps and small generators.

Speeds

Up to 3000 rpm.

Peak torque largest size

18 Nm

Standard bores

3mm to 16mm

Temperature range

-40 °C to +100 °C

Electrically isolating

Yes

Connection

Set Screw

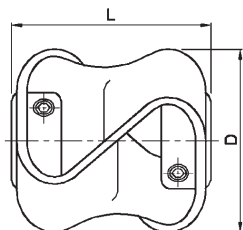

Sizes: 20, 30, 40

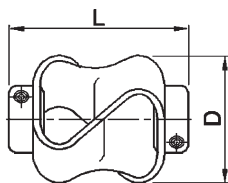

Size: 10

Performance

Coupling Size	Max Torque 1 (Nm)	Max Torque 2 (Nm)	max misalignment / displacement		
			Angular deg	Radial mm	Axial \pm mm
10	0.5	0.8	10	2.6	4.5
20	1.8	3	15	3.2	7.5
30	5	8	15	3.2	8.5
40	10	18	15	3.2	11

Torque 1 = torque at maximum displacement

Torque 2 = torque at 1 deg. angular, 2mm axial and 0.5mm radial displacement

Couplings

Double Loop

Dimensions & Order Codes

Couplings Double Loop

PART NUMBER		Dimensions				
steel zinc plated hubs	stainless steel hubs	Coupling Type & Size	Max Diameter	Length L ± 1.0	Bore length	Max Bores
HPC047.10.----	-	10	27	27	7.9	9.53
-	HPC049.10.----					
HPC047.20.----	-	20	48	48	12.7	12.7
-	HPC049.20.----					
HPC047.30.----	-	30	54	55	16.0	16.0
-	HPC049.30.----					
HPC047.40.----	-	40	56	56	16.0	16.0
-	HPC049.40.----					

Order codes: Please combine the coupling part number in the above table with the bore reference in the standard bores table (see pages below).

Please identify both bores to complete the part number eg. HPC047.10. 14 31

Part Number \varnothing B1 \varnothing B2

Standard Bores *

Bore Size Coupling Size	+ 0.05 / - 0 mm								
	3	3.175	4	4.763	5	6	6.350	7.938	8
10	●	●	●	●	●	●	●	●	●
20						●	●	●	●
30									
40									
Bore ref.	14	16	18	19	20	22	24	27	28

* Couplings with dissimilar bores are non-standard

Couplings

Double Loop

DISCOUNTS

1 - 19	20-39	40-59	60-99	100 +
List Price	-15%	-20%	-25%	-30%

PART NUMBER		Fasteners				PRICE EACH 1-19
steel zinc plated hubs	stainless steel hubs	Size	Torque (Nm)	A/F (mm)	Mass kg x10 ⁻³	
HPC047.10.----	-	M3	0.94	1.5	25	£20.04
-	HPC049.10.----		0.32			£30.06
HPC047.20.----	-	M4	2.27	2.0	92	£22.36
-	HPC049.20.----		2.0			£33.54
HPC047.30.----	-	M5	4.62	2.5	124	£24.68
-	HPC049.30.----		2.1			£37.05
HPC047.40.----	-	M6	7.61	3.0	136	£24.68
-	HPC049.40.----		3.75			£40.53

Couplings Double Loop

Coupling Size	Bore Size	+ 0.05 / - 0 mm							
		9.525	10	12	12.7	14	15	15.875	16
10	●								
20	●	●	●	●	●				
30	●	●	●	●	●	●	●	●	●
40	●	●	●	●	●	●	●	●	●
<i>Bore ref.</i>		31	32	35	36	38	40	41	42

